:

:

:

:

.

.

:

...

" "

()

()

()

(Charge bin)

()

Top Gas

CO₂

(Fuel Gas)

-
-
-
-
-
-
-
-
-
-

...

.(.....)

carry over -

CO2

:

(Magnet Hammer)

(% %)

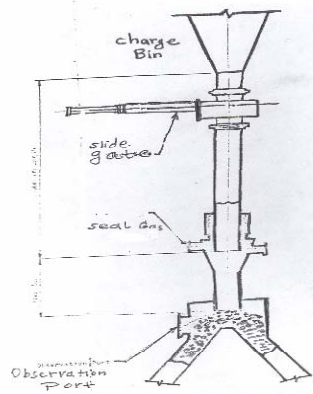

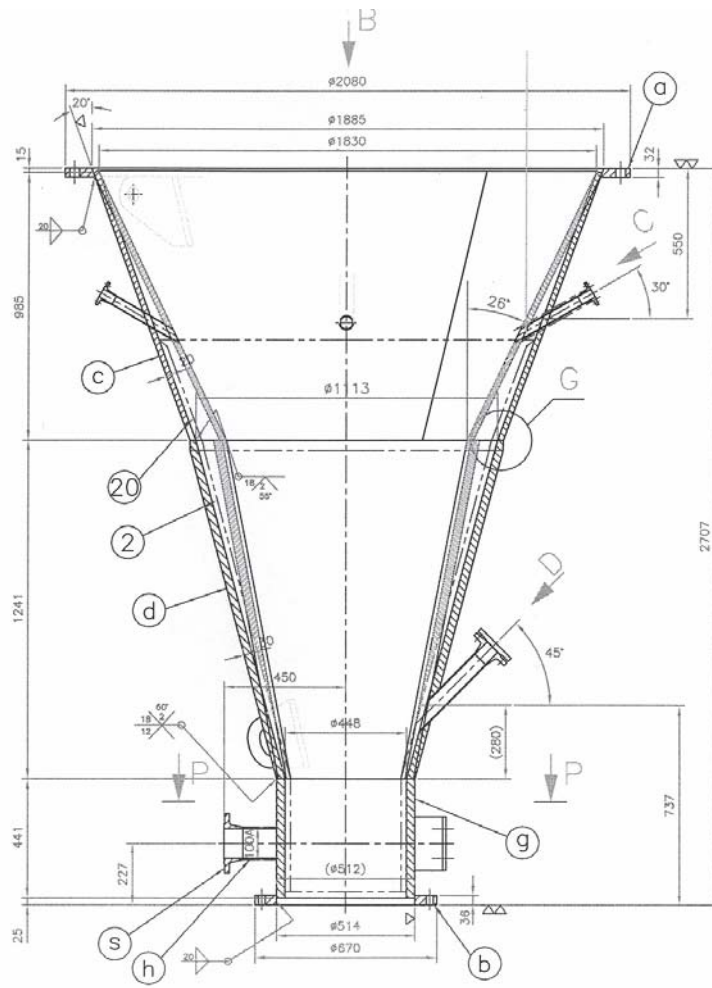

Charge Bin Angle Modification, Material Flow Facilitating and Bridging Reduction (ZAM ZAM Plant Khouzestan Steel Company)

Kazem Bakhtiary¹-Ahmad Hazbeizadeh

2

Abstract

Material (pellet) flow blocking and bridging in charge bin of ZAM ZAM burden furnace is one of the difficulties in MIDREX process and this problem has a close relation with system pressure. Also, an unsafe condition in working area for workers and system apparatus and troubleshooting gets long time and uses man power.

For solving this problem, in annual maintenance, the charge bin angle was modified from 15° to 11°.